

Community College *of* Philadelphia

COUNCIL UPDATE

BUDGET 2023



LEADERSHIP | BOARD OF TRUSTEES



Ajeenah Amir

Director of Civic Engagement and
Community Partnerships, Penn Medicine



Ronald A. Bradley, Jr.



Morgan Cephas

State Representative



H. Patrick Clancy

President and CEO,
Philadelphia Works



Rob Dubow

Director of Finance,
City of Philadelphia



Harold T. Epps, Chair

Senior Advisor,
Bellevue Strategies



Chekemma J. Fulmore-Townsend

President and CEO,
Hamilton Family Charitable Trust



V. Steve Herzog

Chief Operating Officer,
Square One



Sheila Ireland, Secretary

President and CEO,
Philadelphia OIC



Tyrell McCoy

Commanding Officer, Recruitment and
Background Investigation, Philadelphia
Police Department



**Rosalyn J. McPherson,
Vice Chair**

President and CEO,
The ROZ Group, Inc.



Mindy Posoff

Managing Director,
Golden Seeds



**Michael Soileau,
Vice Chair**

CEO, O3



Dominique B. E. Ward, Esq.

Assistant Vice President and Senior
Counsel, Retirement Plan Services,
Lincoln Financial Group



Jeremiah J. White, Jr.

CEO,
White and Associates

TRUSTEES EMERITUS: Robert S. King (d.), Rhonda R. Cohen, Esq.

FAST FACTS

Community College of Philadelphia is the largest public institution of higher education in the City of Philadelphia.

18,861
credit and noncredit students for 2021-2022 academic year

73% receive some type of financial aid

85% of recent graduates stay and work in Philadelphia metro area

100+ AA and certificate programs offered

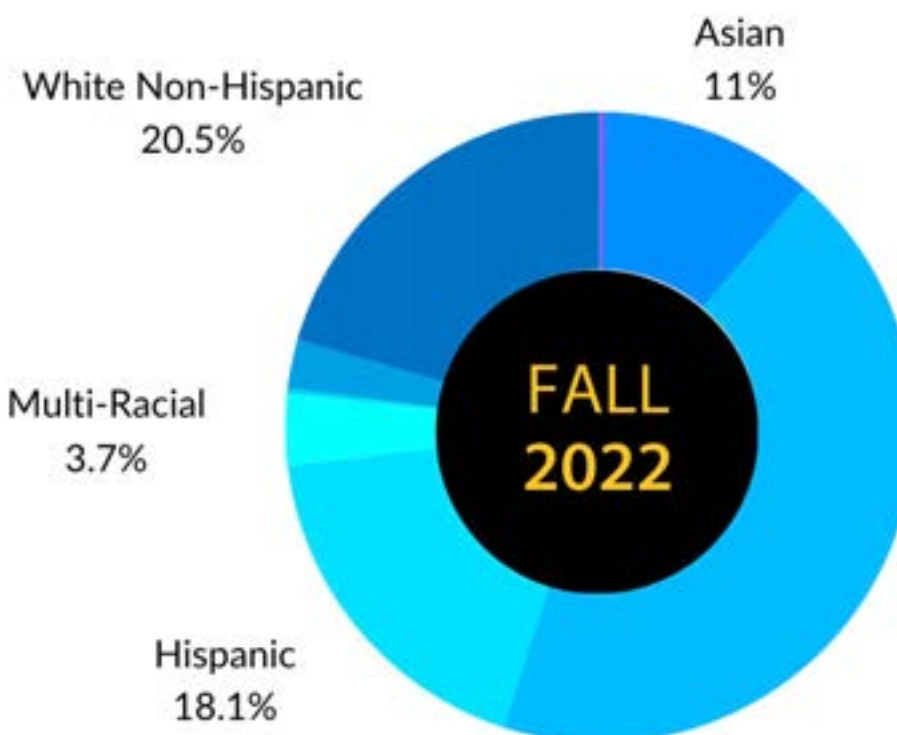
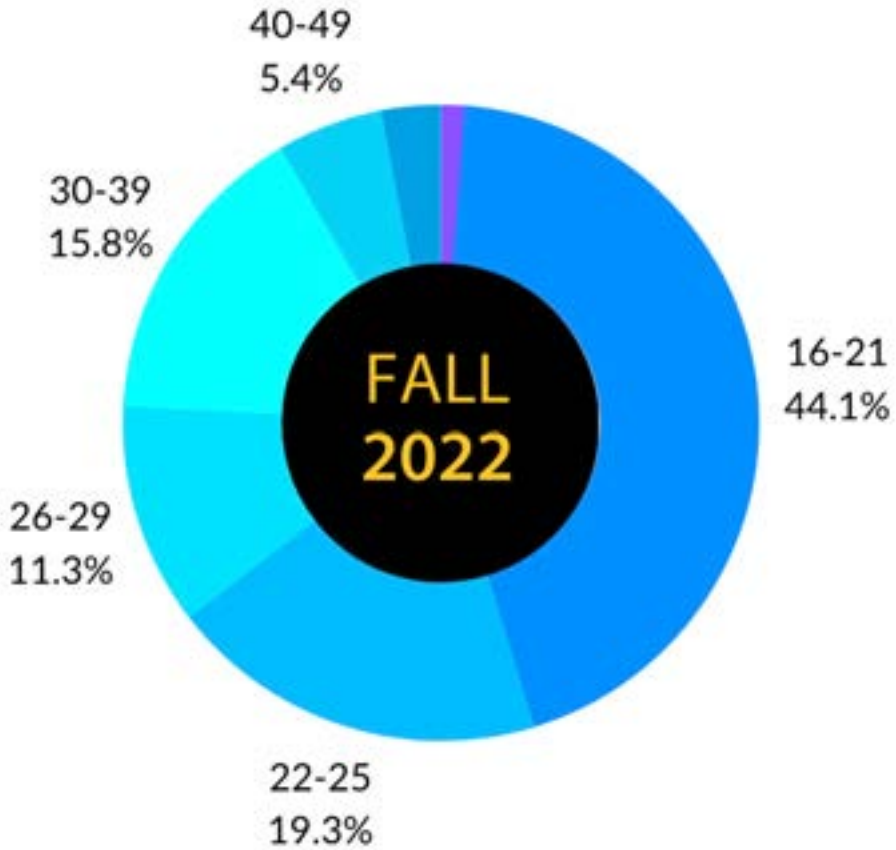

Total Students: 11,637



“CCP [...] taught me so much. I can do anything. I am so prepared to tackle anything that comes my way.”
—Christopher B., Class of 2022

THE COLLEGE'S STUDENT POPULATIONS REPRESENTED BY COUNCIL DISTRICT

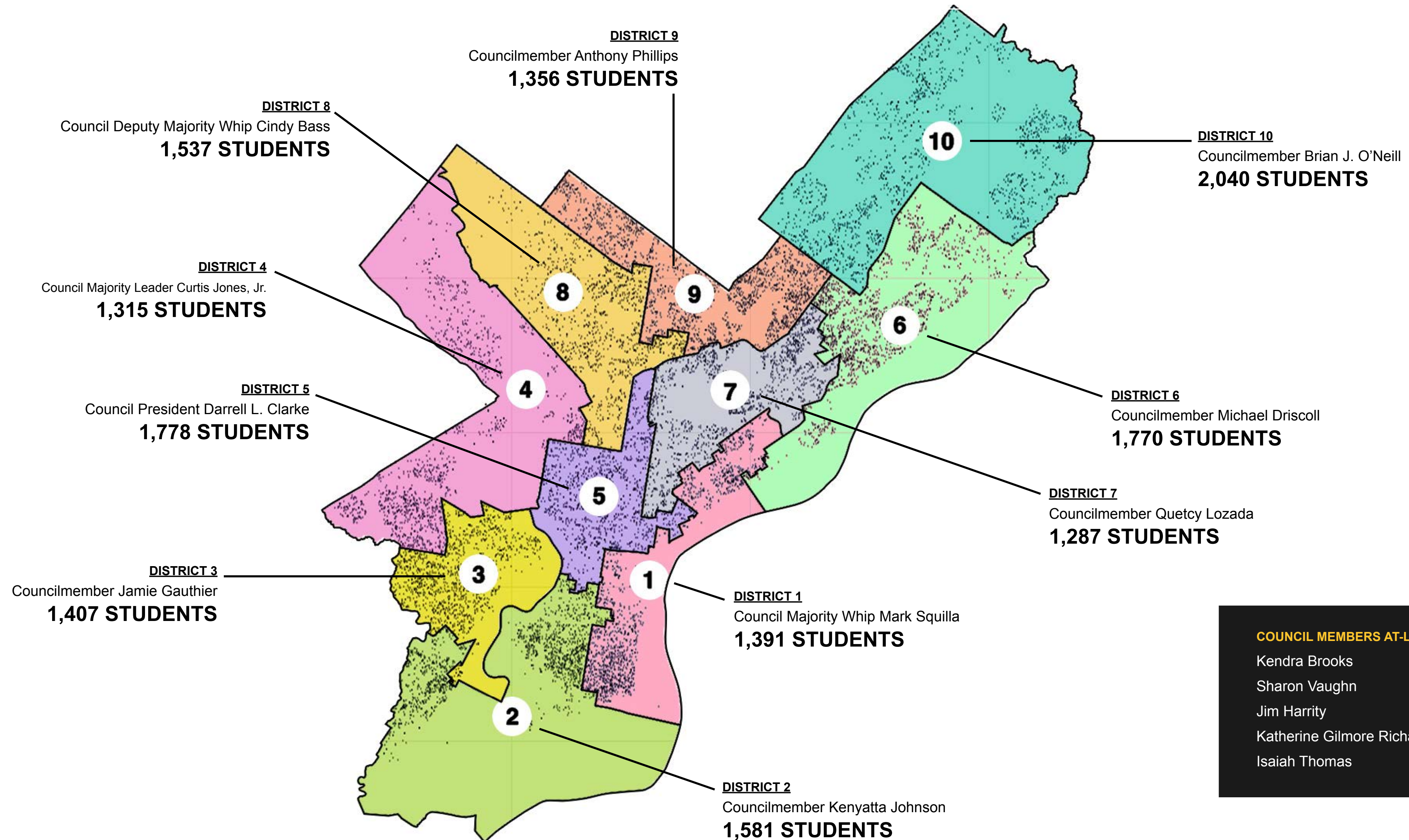

COUNCIL MEMBERS AT-LARGE

- Kendra Brooks
- Sharon Vaughn
- Jim Harrity
- Katherine Gilmore Richardson
- Isaiah Thomas

FY24 BUDGET REQUEST

\$51 MILLION

Includes:

- **\$11.7 million for the Octavius V. Catto Scholarship**
- **\$150,000 for dual enrollment**

\$15 MILLION

- *One-time funding for capital programs*



FY24 CAPITAL PROGRAMS

\$15 million in one-time funding for capital projects will support improvements to help enhance student success.

Highlights include:

- *Renovation of the **Single Stop** office*
- *Renovation of the **Great Hall** for **academic and student programming***
- *Creation of a **simulation and skills lab** for **Nursing program***
- ***Improved lighting** to enhance **safety and security***
- *Renovation of outdated **bathrooms***
- *Updating **Athletics Center locker rooms** and **bathrooms***
- *Replacing the **Dental Clinic** floor*



THE ECONOMIC VALUE OF THE COLLEGE

*As of FY 2019-2020, the College added **\$631.3 MILLION IN ADDED INCOME** to Philadelphia County.*

***FOR EVERY DOLLAR** invested to support the College, Pennsylvanians gain an average of **\$9.40** in added **INCOME** and **SOCIAL SAVINGS**, while **students gain \$5.90** in lifetime earnings.*

*Approximately **7,500 JOBS** in the county were **SUPPORTED BY THE COLLEGE IN FY 2019-2020.***

STUDENT SUCCESS



Gateway to College, which helps out-of-school students from Philadelphia, 21 and under, earn their GED and college credits, received a 2022 Graduation Achievement Award from Achieving the Dream for exceeding the #GatewayToCollege graduation benchmark.



In the Class of 2022, 188 students transferred to a 4-year institution, with one student enrolling at Penn!

CLASS OF 2023
1,531 Graduates

1,479
ASSOCIATE DEGREES

131
CERTIFICATES

**as of April 24, 2023*

This May, **107 STUDENTS** will
Earn a College Degree AND
High School Diploma

98

Students from
PARKWAY CENTER CITY
MIDDLE COLLEGE

9

MATHEMATICS, SCIENCE
AND TECHNOLOGY
(MaST) Students

SCHOLARSHIPS SUPPORT STUDENT SUCCESS

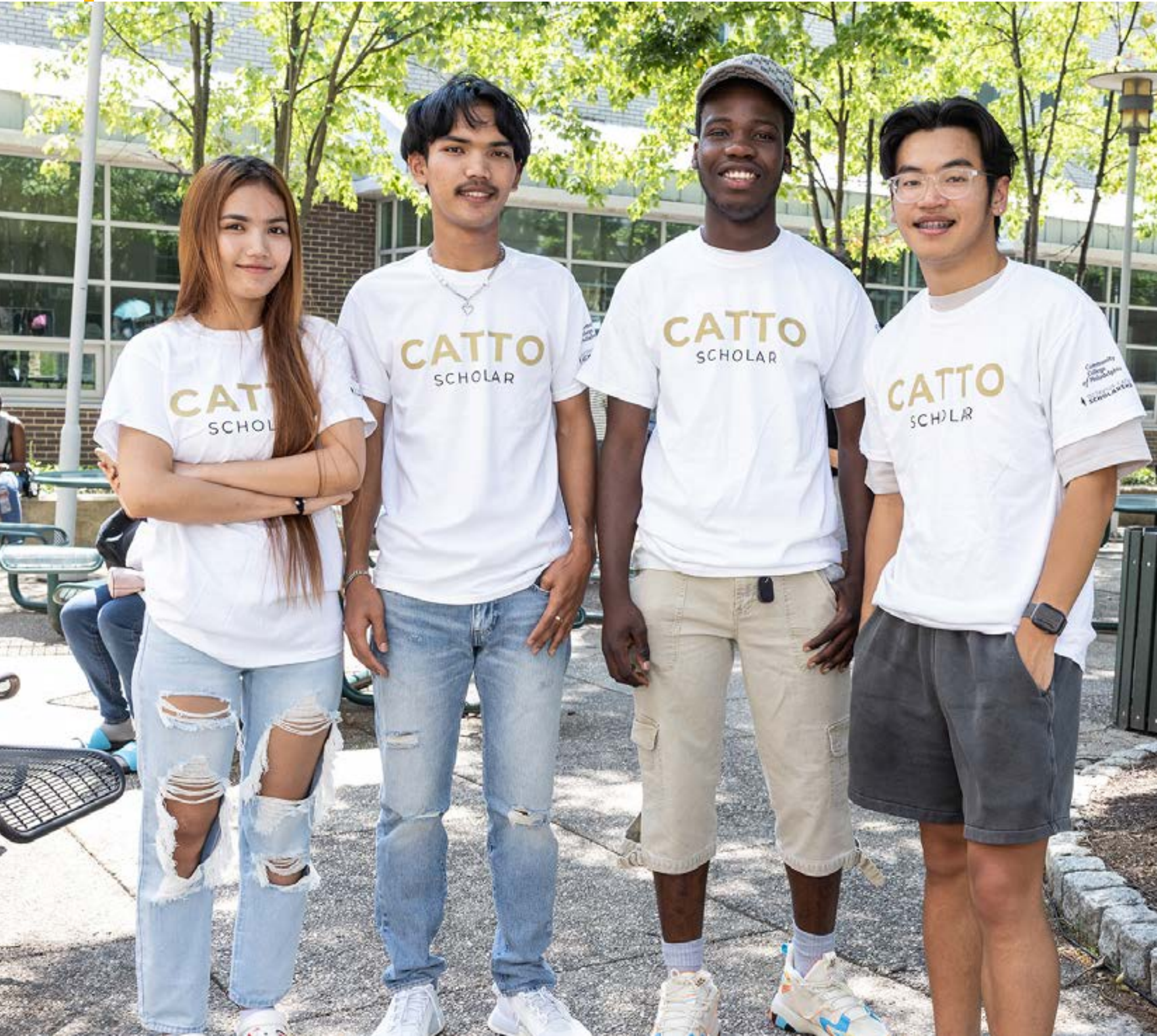

OCTAVIUS V. CATTO SCHOLARSHIP

A collaborative effort with the City of Philadelphia to pay costs not covered by financial aid, allowing eligible CCP students to get a degree debt-free with wraparound support services.



PROGRAM IMPACT

MORE THAN **1,100 CATTO SCHOLARS** SINCE JAN. 2021
STUDENTS FROM FIRST COHORT ELIGIBLE TO GRADUATE IN **MAY 2023**

STUDENT SUPPORT



OFFERING HOUSING FOR STUDENTS IN NEED

The **Shared Housing Program** partnership with the **Philadelphia Housing Authority** provides **low-cost apartments** for housing insecure students at the College, **with a focus on students who have experience in the foster care system.**

Single Stop students have higher:
Graduation and semester-to-semester persistence rates, GPAs

Since October 2013, Single Stop has served **19,168** students and their families, connecting them to



\$30+

MILLION IN FINANCIAL RESOURCES

5,800+

TAX FILINGS

2,939

FINANCIAL COUNSELING SESSIONS

865+

STUDENTS RECEIVED LEGAL AID



ENDING STUDENT HUNGER ON CAMPUS

Since 2017, the College's **Food Collaborative** has been addressing student hunger through our **Snack Rack** and **Grady's Garden**, supporting **more than 2,800 students** by providing **more than 8,735 meals.**

CENTER FOR MALE ENGAGEMENT AND I AM MORE



Support coaches work with male students of color to make them aware of the resources available to them at the College, help them adjust to a college environment, and help them balance their academic and personal responsibilities.

The annual Summer Enrichment Program offers workshops and a stay at a regional college campus to build a foundation for success.



Luis "Suave" Gonzalez, the first support coach for the College's I Am More Reentry Engagement program, is tasked with supporting students who are navigating life after being involved in the criminal justice system.

"Suave," a podcast detailing Luis' life during and after serving more than 30 years in prison, won a Pulitzer Prize for audio recording in May 2022.

SAXBYS CAFÉ



Allows students to earn money while in school and receive business training and experience through the Saxbys Experiential Learning Platform.

THE ENTIRE CAFÉ IS STUDENT-RUN!

*The **Student CEO (S.CEO)** role is filled by an undergraduate student who earns full academic credit (at least 12 credits toward select programs through Prior Learning Assessment) by Community College of Philadelphia.*

- *S.CEOs hold a 6 month term*
- *Semester leave of absence*
- *Earn while you learn model*
- *Full-time employment (\$15k stipend)*

UPDATED SCIENCE LAB EQUIPMENT

NEW AND IMPROVED LAB EQUIPMENT

To provide world-class facilities and learning environments for students, science labs have been updated to include the following:

- *Microscopes (compound, dissecting, fluorescence, inverted, phase contrast)*
- *Fermenters*
- *Thermal cyclers (traditional PCR and qPCR)*
- *High-performance liquid chromatography (HPLC) with fraction collection and UV-vis detectors*
- *Gas chromatographs with mass spectrophotometer and FID detectors*
- *Fourier-transform infrared spectroscopy (FTIR)*

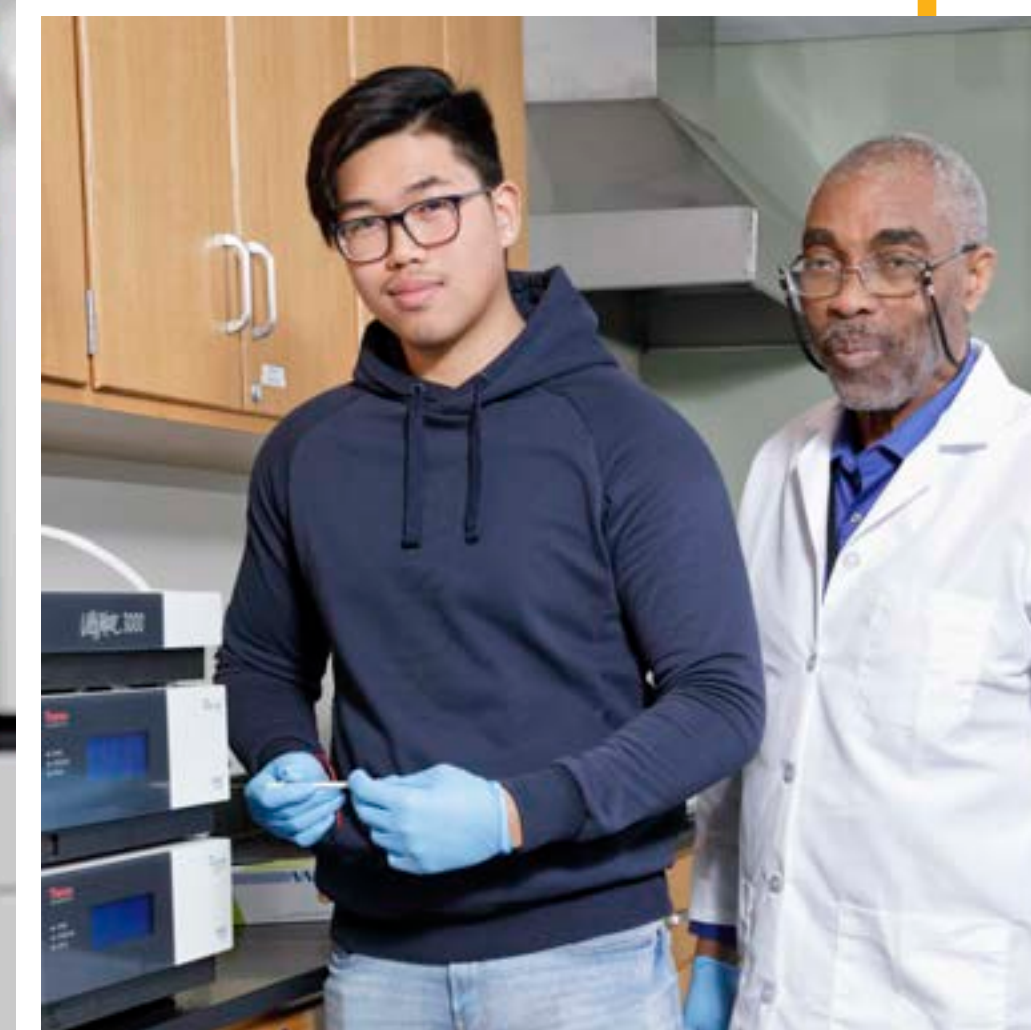

LIFE SCIENCES/GENE AND CELL THERAPY



Examples of **JOBS** in **CELL** and **GENE THERAPY** Sector:

- **Manufacturing** Manufacturing Associate
- **Laboratory Technician** Associate Lab Technician
- **Project Coordinator**
- **Animal Research** Animal Research Technician
- **Research** Research Technician II
- **Quality Control** Analytical Laboratory Technician

ASSOCIATE DEGREE Programs

- **A.A. in Biology**
- **A.S. in Biology**
- **A.S. in Chemistry**
- **A.A.S. in Applied Engineering Technology**
- **A.S. in Engineering**
- **A.S. in Mathematics**
- **A.A.S. and PC in BMET**

ASEPTIC TECHNIQUE TRAINING Non-credit Course

Provides **hands-on immersive laboratory experience** in **GMP** environment.

Collaboration with **Wuxi** and **Integral Molecular**



ATHLETICS CENTER RENOVATIONS



ATHLETICS CENTER

The College cut the ribbon on the updated Athletics Center during its ROARchella Spring Fling Festival.

The upgrades will make the facility better for student and staff use, and for those attending games and events in the gym.

Updates include:

- **New wood floor and backboards**
- **New bleachers featuring the College's logo**
- **Two new 10'x17' LED scoreboards**
- **Performance LED lighting**
- **New paint**

LIBRARY AND LEARNING COMMONS

SPACES THAT MEET STUDENT NEEDS

Collaborative areas for classes and student groups

Individual study rooms

Computers and video equipment for academic work

Houses tutoring and other support services

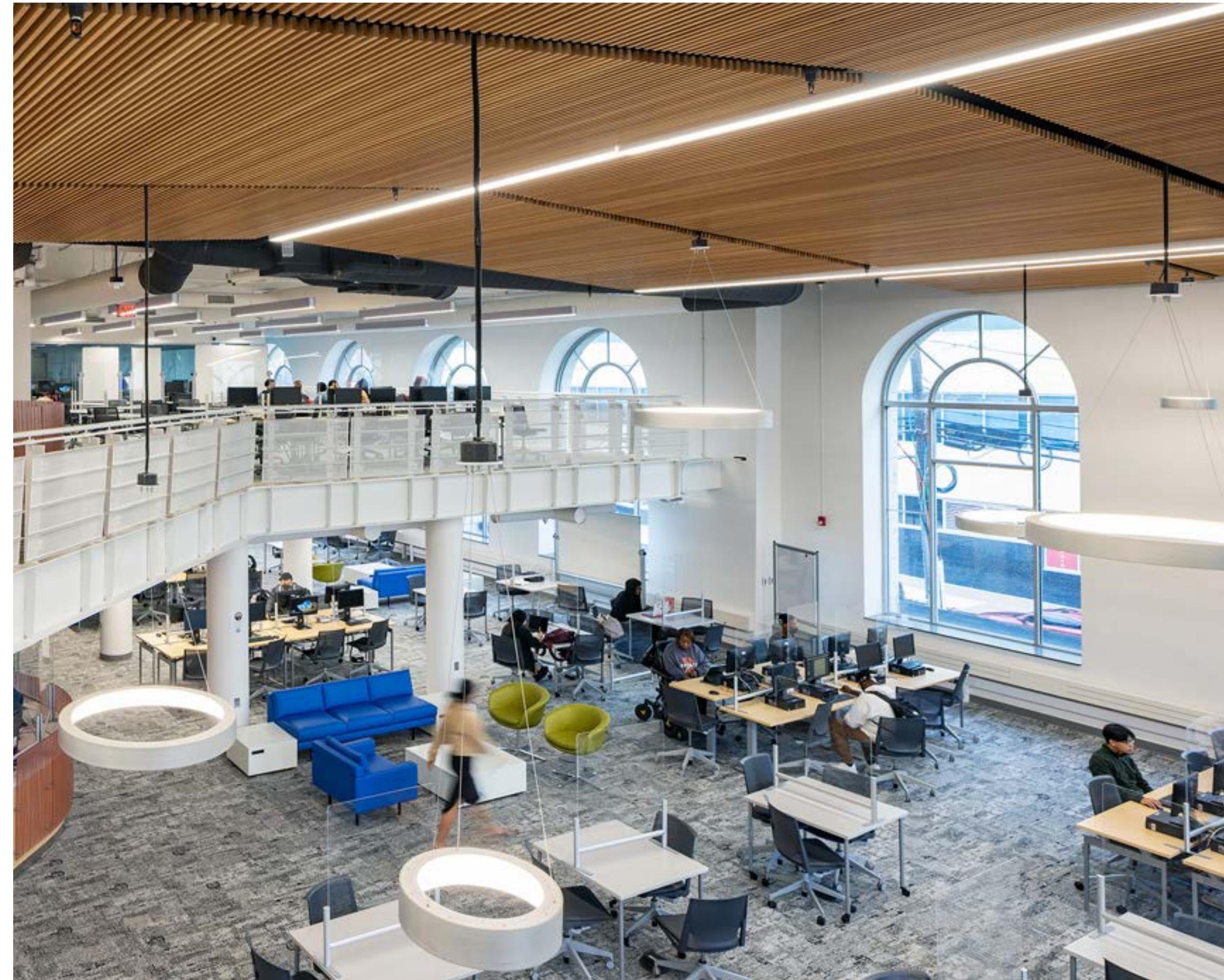

CAREER AND ADVANCED TECHNOLOGY CENTER



**USHERING IN A NEW ERA
OF CAREER READINESS**

*Opened in West Philadelphia
in August 2022*

*State-of-the-art teaching and
learning facility designed to
introduce Philadelphians to the
transportation, manufacturing,
and health care industries*

SUPPORTING PHILADELPHIA'S SMALL BUSINESS COMMUNITY



POWER UP YOUR BUSINESS

Since 2017, the College's **Power Up Your Business** program has supported **hundreds of entrepreneurs** in the Philadelphia region.

The **free, 12-week peer-based learning program** provides small business owners with **training, coaching, and targeted technical assistance to grow their business, boost revenue, and make an impact in their communities.**

10,000 SMALL BUSINESSES

Launched in 2009 by Goldman Sachs and the Goldman Sachs Foundation, the 10KSB program is designed to **help entrepreneurs create jobs and economic opportunity** by providing them with greater **access to education, financial capital, and business support services for free.**

WORKFORCE DEVELOPMENT PROGRAM EXAMPLES

HEALTH CARE & WELLNESS

- Massage Therapy (*In-person NERC*)
- Dental Assistant (*Hybrid/Main/CATC*)
- Dialysis Technician (*Online & In-person/Main*)
- Clinical Medical Assistant (*Hybrid*)
- Pharmacy Technician (*Online & In-person*)
- Nurse Assistant (*In-person/Main/CATC*)
- Sterile Processing Technician (*In-person/Main*)

MANUFACTURING/LOGISTICS/ INFRASTRUCTURE

- Computer Numerical Control (CNC) Precision Machining (*In-person/West/CATC*)
- Electro-Mechanical & Industrial Maintenance (*In-person/Main/CATC*)
- Gas Pipeline Mechanic (*In-person/CATC*)
- Safety Inspection Mechanic Training Certification & Emissions Inspector Certification (*CATC*)

- Embedded Programs: Blueprint Reading, Shop Math, OSHA (*CATC*)
- Certified Production Technician (*In-person, CATC*)
- Commercial Driver's License (CDL) (*In-person/NERC*)

EDUCATION & BEHAVIORAL HEALTH

- Child Development Associate (Online)
- Faith & Spiritual-based Counseling

BUSINESS/FINANCE

- Bookkeeping (*Online & In Person/Main*)
- QuickBooks
- Customer Service & Sales

TECHNOLOGY

- A+ Certification
- CompTIA Security +
- Coding Certificate
- Cybersecurity

PROFESSIONAL DEVELOPMENT

- Diversity, Equity & Inclusion Institute
- Microsoft Word, Excel
- ServSafe
- AutoCad (*CATC*)
- Logistics and Supply Chain Management Basics
- Grant Writing
- Nonprofit Management

Community College *of* Philadelphia

THANK
YOU

